

DKT WAVE2 AIR

Quick start guide



Installation af den første enhed

Tilslut den første DKT WAVE2 Air til strømforsyningen og din router/gateway/modem med det vedlagte Internetkabel. Efter ca. et minut, vil den nederste LED lyse orange og du er klar til at opsætte netværksnavn og password.

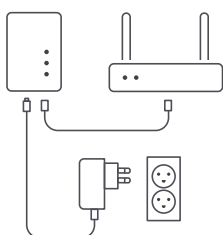

Tilføj flere enheder med Internetkabel

Tilslut blot strømforsyning og internetkabel, vent til LED'erne lyser grønt, og så er du færdig.

Dette er den anbefalede måde at tilslutte andre DKT WAVE2 Air enheder.

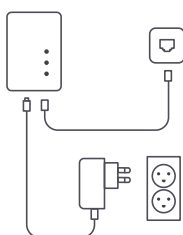

Nulstilling af enhed

For at nulstille DKT WAVE2 Air enheden, skal du holde pardannelse/nulstil knappen nede i mere end 10 sekunder indtil alle 3 LED'er blinker. Slip herefter knappen.

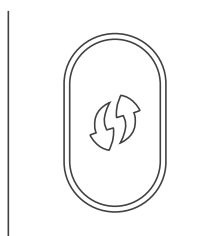

DKT WAVE2 Air

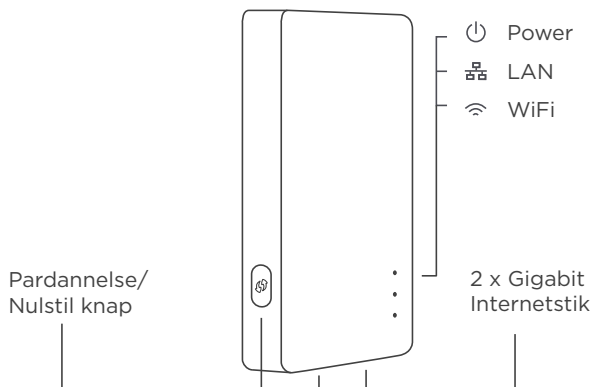

Netværksnavn (SSID) og password

- 1 Brug din PC eller smartphone. Kig efter WiFi netværket med navnet GUIDExxxxx, og tilslut.
- 2 Giv dit nye netværk et navn (SSID) og et password.

Find nu dit nye netværk under indstillinger.



Tilføj flere enheder med trådløst

Tilslut strømforsyningen og vent 1-2 minutter, indtil LED'erne lyser orange. Gå tilbage til den første enhed, og hold pardannelse/nulstil knappen inde i et par sekunder, og gør derefter det samme på efterfølgende enheder. Vent indtil "WiFi" lyser grønt, og så er du færdig.

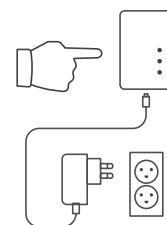

Info & yderligere hjælp



Besøg vores website for yderligere information og fejlfinding.
www.wave2.dk

Download DKT WAVE2 App'en og brug den til at opdatere firmware, monitorere dit netværk med mere.



DKT WAVE2 App til iOS



DKT WAVE2 App til Android



DKT WAVE2 AIR

Quick start guide



DKT WAVE2 Air

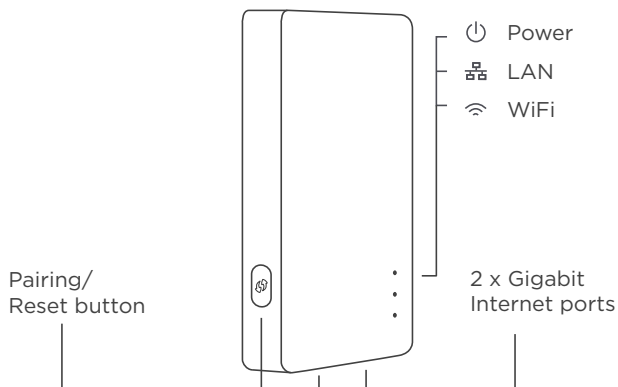

Installation of the first unit

Connect the first DKT WAVE2 Air to power and to your router/gateway/modem with the provided Internet cable. After about a minute, the last LED will light amber and you're ready to enter network name and password.

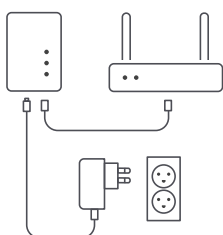

Network name (SSID) and password

- 1 Use your PC or smartphone. Look for the WiFi Network named GUIDExxxxx, and connect.
- 2 Type in the name (SSID) and password of your new WiFi network.



Find and connect to your new WiFi network under settings.

Add further units using Internet cable

Just connect the power supply and internet cable to the unit, wait for the LEDs to turn green, and you are good to go.

This is the recommended method of adding a second DKT WAVE2 Air unit.

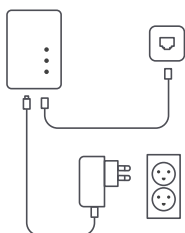

Add further units using WiFi

Connect the power supply to the unit, and wait 1-2 minutes, until the LEDs turn amber. Go back to the first unit. Press and hold the pairing / reset button a few seconds. Do the same on the unit you wish to connect. Wait a moment, until the first and third LED turn green, and you are good to go.

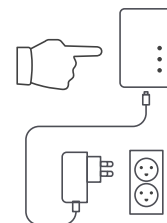

Factory reset

To reset the DKT WAVE2 Air unit, press and hold the pairing/reset button for more than 10 seconds until all 3 LEDs are blinking, then release it.

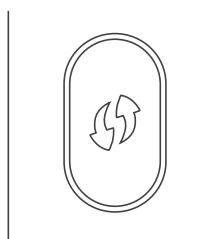

Info & further help



For further information and troubleshooting, please visit our website www.wave2.dk

Download the DKT WAVE2 App and use it to update the firmware, monitor your network and more.



DKT WAVE2 App for iOS



DKT WAVE2 App for Android

